

## PUMP SYSTEMS WITH PNEUMATIC INDUCTOR FOR 185 KG DRUMS



PumpMaster 45 and PumpMaster 60 grease pumps mounted onto an air operated inductor plate for use with high viscosity, hard to pump greases directly from 185 kg drum.

When the double lip inductor plate is attached to the lower end of the pump tube, it exerts pneumatic, weight and atmospheric pressure on the material forcing pump priming. The inductor plate also serves as protection against contaminants and eliminates material waste.

There are two Power Ram models. The **BASIC Power Ram** includes:

- Follower plate with double Buna-N lip seals guide rods
  - Platform base with drum retainers.
  - Controls for raising and lowering the inductor plate with pressure regulator.
  - Ball valve for releasing the vacuum manually when the plate is removed from an empty drum.
  - Pump adapter for fixing the pump to the follower plate
- Pump air connection accessories are not included.

The **AUTOMATIC Power Ram** includes the same features as the Basic model plus:

- Pump air connection accessories.
- On / Off control of the pump.
- Up / Down control of the ram for easy drum exchange.
- Two independent air pressure regulators, one for the pump and the other for the power ram cylinders.
- Pump / Ram independent air pressure gauge.
- Automatic empty drum pump shut-off safety feature.
- Automatic Vacuum release.

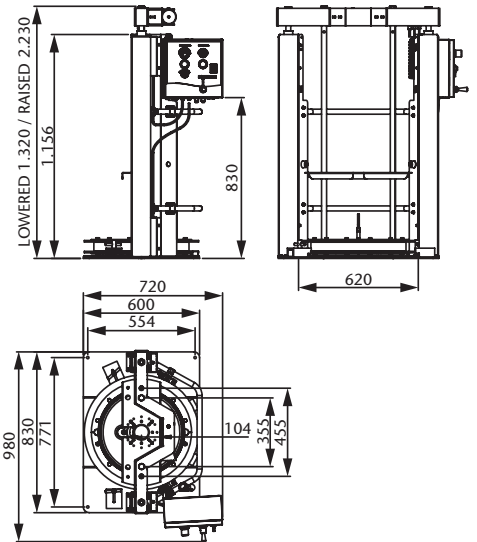

Dimensions in mm

PART No. BASIC POWER RAM	PART No. AUTOMATIC POWER RAM	PUMP
534 421.001	534 421	531 420 (PM45 - 40:1)
534 721.001	534 721	531 720 (PM45 - 70:1)
534 121.001	534 121	532 130 (PM60 - 12:1)
534 821.001	534 821	532 820 (PM60 - 80:1)