

RM-Power Compact Reels For Cable

Compact reels with 15 meters maximum hose capacity. Reels with high resistance thermoplastic enclosure. Compact design, with wide outlet for a comfortable and friction free cable extension. All reels include pivoting bracket, cable specified for each model, and cable overload breaker. For use with 230 V – 50 Hz only.

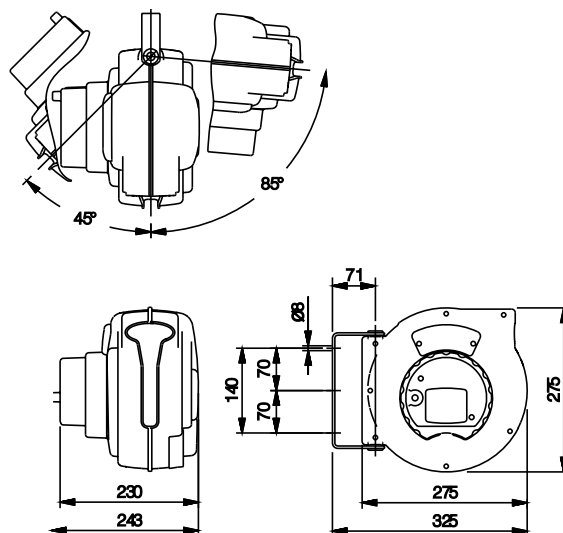

612 100



Hose
Reels

MODELS

Part No.	Cable Length	Type	Inlet	Outlet	Power
612 100	15 m	H 05 VV (F) 3 x 1,5 mm ²	230 V (I) - 50 Hz (F)	230 V (I) (F)	800 W - 2.000 W (fully extended cable)
612 104	15 m	H 05 VV (F) 3 x 1,5 mm ²	230 V (I) - 50 Hz (M)	230 V (I) (M)	800 W - 2.000 W (fully extended cable)
612 700	15 m	CAT-5E	RJ-45	RJ-45	-

612 700

