

V DC PUMPS ISCOMAT DC

**MADE
IN
ITALY**

EN. DC oil pumps. A new and complete range of pumps for transferring and delivering oil, operated by direct current motors. These products are especially designed for transferring oil from drums in situations and locations where electricity or pneumatic connections are unavailable.

ES. Bombas para aceite de corriente continua. Una nueva y completa gama de bombas para trasegar y suministrar aceite, accionadas por motores de corriente continua. Estos productos han sido pensados para aquellas aplicaciones en las que se debe trasegar el aceite del bidón sin contar con conexión a la línea eléctrica o a la instalación de aire comprimido.

RU. Масляные насосы постоянного тока. Новая и полная серия насосов для перекачивания и подачи масла с приводом от двигателей постоянного тока. Эти изделия предусмотрены для перекачивания масла из бочки в местах, в которых отсутствует соединение с электросетью или источником сжатого воздуха.

PERFORMANCE

- | | | |
|---|--|---|
| <ul style="list-style-type: none"> - Flow rate 4 - 10 l/min. - Operating pressure: 5 bar - Viscosity up to 2000 cSt (Viscomat DC 60/2 max viscosity of oil 600 cSt) - Duty cycle: 30 min - Noise level below 65 dB | <ul style="list-style-type: none"> - Caudal 4 - 10 l/min - Presión de funcionamiento: 5 bar - Viscosidad hasta 2000 cSt (Viscomat DC 60/2 viscosidad máx. aceite 600 cSt) - Ciclo de funcionamiento: 30 min - Nivel sonoro inferior a 65 dB | <ul style="list-style-type: none"> - Расход от 4 до 10 л/мин - Рабочее давление: 5 бар - Вязкость до 2000 сСт (Viscomat DC 60/2 макс. вязкость масла 600 сСт) - Рабочий цикл: 30 мин - Уровень шума ниже 65 дБ |
|---|--|---|

DIMENSIONS

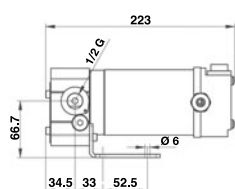

VISCOMAT DC 60/1

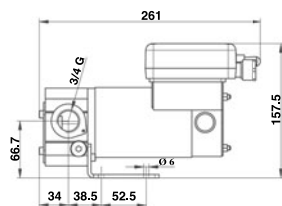
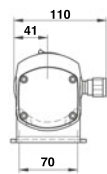

VISCOMAT DC 60/2

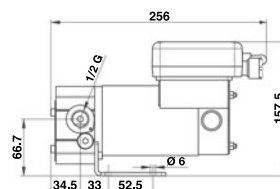
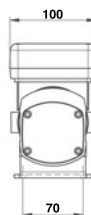

VISCOMAT DC 120/1

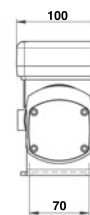

PRODUCTS' RANGE WEIGHT AND PACKAGING

Code	Weight		Packaging		
	kg	lbs	mm	inch	pcs/box
F0030902A	3	6,6	200x120x140	7,9x4,7x5,5	1
F0030901A	4,9	10,8	345x175x255	13,6x6,9x10	1
F0030900A	4,9	10,8	345x175x255	13,6x6,9x10	1
F0031002A	3	6,6	200x120x140	7,9x4,7x5,5	1
F0031001A	4,9	10,8	345x175x255	13,6x6,9x10	1
F0031000A	4,9	10,8	345x175x255	13,6x6,9x10	1
F00311000	4,9	10,8	345x175x255	13,6x6,9x10	1
F00311010	4,9	10,8	345x175x255	13,6x6,9x10	1



PUMPS

ANTIFREEZE
BIO DIESEL
DIESEL
FOOD
GASOLINE
GREASE
KEROSENE
OIL
AdBlue®
WATER
WINDSCREEN

Flow-rate
up to
10 l/min
(up to 2,8 gpm)

Viscosity
up to
2000
cSt



DISPENSERS

PUMPS

METERS

NOZZLE METERS

NOZZLE

SPECIAL EQUIPMENTS

FLUID MONITORING

ACCESSORIES

FILTERING



VISCOMAT DC 60/1

VISCOMAT DC 60/2
VISCOMAT DC 120/1

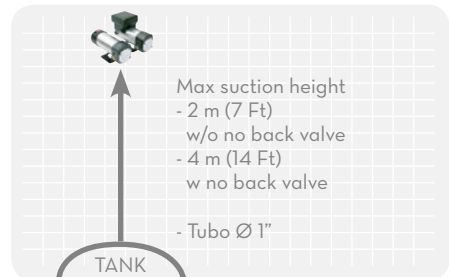
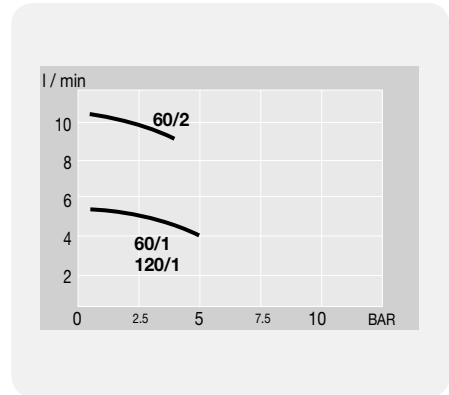

FEATURES



ON DEMAND

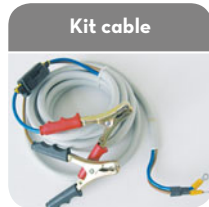

Code	Description	60/1 12V	60/2 12V	60/1 24V	60/2 24V	Fuse on the cable
R14437000	Kit cable 2 m (12V/24V)	YES		YES		
R10011000	Kit cable 2 m (12V)		YES			YES
R10040000	Kit cable 2 m (24V)				YES	YES
R14438000	Kit cable 4 m (12V/24V)	YES		YES		
R10041000	Kit cable 4 m (12V)		YES			YES
R10039000	Kit cable 4 m (24V)				YES	YES

PRODUCTS' RANGE TECHNICAL DATA

Code	Description	Fluids type	Flow-rate		Pressure		Voltage			rpm	Inlet Outlet	Press. switch
			l/min	gpm	bar	psi	DC Volt	Power Watt	Amp. max.			
F0030902A	Viscomat DC 60/1 12 V	☉	4	1,2	5	70	12	150	18,5	2900	1/2" BSP	NO
F0030901A	Viscomat DC 60/2 12 V (*)	☉	10	2,8	4	57	12	300	35	2900	3/4" BSP	NO
F0030900A	Viscomat DC 120/1 12 V	☉	5	1,4	10	140	12	200	26,5	2900	1/2" BSP	NO
F0031002A	Viscomat DC 60/1 24 V	☉	4	1,2	5	70	24	150	9,5	2900	1/2" BSP	NO
F0031001A	Viscomat DC 60/2 24 V (*)	☉	10	2,8	4	57	24	300	18	2900	3/4" BSP	NO
F0031000A	Viscomat DC 120/1 24 V	☉	5	1,4	10	140	24	200	19,5	2900	1/2" BSP	NO
F00311000	Viscomat DC 120/1 12 V PST	☉	5	1,4	10	140	12	200	22,5	2900	1/2" BSP	YES
F00311010	Viscomat DC 120/1 24 V PST	☉	5	1,4	10	140	24	200	19,5	2900	1/2" BSP	YES

(*) For Viscomat DC 60/2 max oil viscosity 600 cSt